

S<sup>c</sup> Carolina Pursuant to a warrant from John Thomas Esq. Com<sup>r</sup> of Loc. I have dated the 6<sup>th</sup> July 1793. I have admeasured & laid out unto Richard Sully a Tract of 29 acres of Land in Rowdy County On a Small Branch of Carmons Creek the waters of B<sup>r</sup> River. & hath such shape and marks as the above plat Represents Surveyed the 12<sup>th</sup> day of July 1793  
Geo Harbord  
Jr

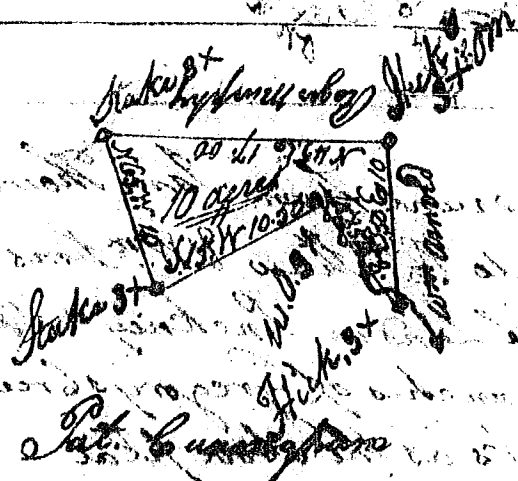

S<sup>c</sup> Carolina

Pursuant to a warrant from John Thomas Esq. Com<sup>r</sup> of Locations. I. Saluda dated the 10<sup>th</sup> day of July 1793. I have admeasured & laid out unto Roger Murphy Jun<sup>r</sup> a Tract of 10 Acres of Land on a Branch of Carmons Creek bounding W. on Pat. Cunningham's Son W. on W. on W. on Roger Murphy and hath such shape and marks as the above plat Represents. Surveyed the 11<sup>th</sup> July 1793  
J. Rodgers  
Jr

10 Chas. G. Guch